



# SLLP LED PANEL LUMINAIRE

Project:	
Type:	
Note:	

## DESCRIPTION

Typically used to replace 2'x2' and 2'x4' fluorescent fixtures, the LED flat panel is designed to lay in drop ceilings in offices, schools, and healthcare applications. The flat panels are fully dimmable, and are compatible with building controls, motion sensors, timers, and daylight harvesting systems.

The design of the panels produces an even, consistent shadowless light. The LEDs enable long life, high lumen maintenance, and are low maintenance and constructed without hazardous materials



## SPECIFICATION FEATURES

### Construction & Materials

- Aluminum frame maximizes LED lifetime and optimal performance
- Light weight design allows for a less obtrusive installation

### Electrical System

- High efficiency driver
- Input Voltage: 120-277V, 347V/480V optional, 50/60Hz
- Operating Temperature: -20°C (-4°F) to 40°C (104°F)
- 0-10V Continuous dimming
- Power Factor: >0.90
- Total Harmonic Distortion: <15%

### Optical System

- High impact polycarbonate optics provides even distribution
- Frosted lens provides maximum glare reduction

### LED

- CRI: 80+,90+, 95
- Color Tunable 3000K to 5000K
- Calculated L<sub>70</sub> Lifetime: 349,000 hours @25°C
- Reported L<sub>90</sub> Lifetime: 101,000 hours @25°C

### Warranty

- 10 Years

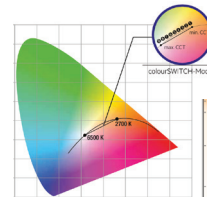

DR Dynamic Range 3000K to 5000K

## DIMENSION

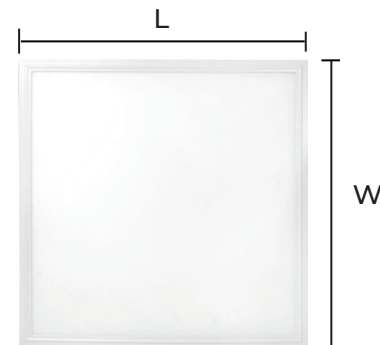
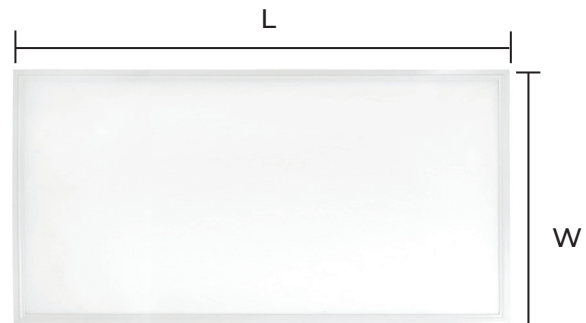

Model	L	W	H
1x4	1213	303	43
2x2	603	603	43
2x4	1213	603	43



Example: SLLP-24-50-CS-80-SD-SE

SLLP	Size	Wattage	CCT	CRI	Driver	Efficacy
SLLP= LED Panel	14=1x4 22=2x2 24=2x4	15=15W 17=17W 20=20W 25=25W 30=30W 35=35W 40=40W 45=45W 50=50W 55=55W	30=3000K 35=3500K 40=4000K 50=5000K  CS=CCT Selectable 3000K/3500K/ 4000K/5000K  DR=Dynamic Color Tunable Range 3000K - 5000K	80=80CRI 90=90CRI 95=95CRI	SD=Standard Driver Power Selectable, 0-10V Dim  TD= Wireless BLE Tunable Driver	SE=Standard Efficacy 130 LPW  HE=High Efficacy 150 LPW

Accessories	
<p><b>Wireless Accessories</b></p> <p><b>Sensors</b> CF=DC powered dual channel PIR motion &amp; daylight sensor</p> <p><b>Switches</b> CAI=AC powered interface for push, toggle and rotary switches CIV=Wireless 4 button switch CTV=Wireless 5 button switch RTS=Wireless 8 function Rotary Switch</p> <p><b>Gateway &amp; Extenders</b> ECHOC=Beacon &amp; range extender LINCC=Gateway with ethernet &amp; RTC</p> <p><b>Emergency Inverters</b> EMDW-10=10W Emergency Inverter Wireless Pack EMDW-20=20W Emergency Inverter Wireless Pack</p>	<p><b>Standard Accessories</b></p> <p><b>Emergency</b> EMD-10=10W Emergency Battery Backup Pack EMD-20=20W Emergency Battery Backup Pack GTD=Generator Transfer Device</p> <p><b>Dimmers</b> LVDC-A019=Rotary 0-10V Dimmer</p> <p>WMS=Wired 0-10V switch with motion sensor WOS=Wired 0-10V switch</p> <p><b>Mounts</b> SMK=Surface Mounting Kit DMK=Drywall Mounting Kit</p>

Emergency Battery Pack Options - Field Installable

Battery Model Number	Wattage	Runtime(minutes)	Lumen Output	Other
EMD(W)-10	10W	90	1300-1500	Self Diagnostic
EMD(W)-20	20W	90	2600-3000	Self Diagnostic

How does the control platform works?

1. Install the SLLP troffers with integrated smart sensor or wireless driver
2. Install the wireless self-powered wall switches
3. With Starco app, pair the troffers with the wall switches and any additional stand-alone sensors
4. Customize the sensor settings and fixture schedules as needed

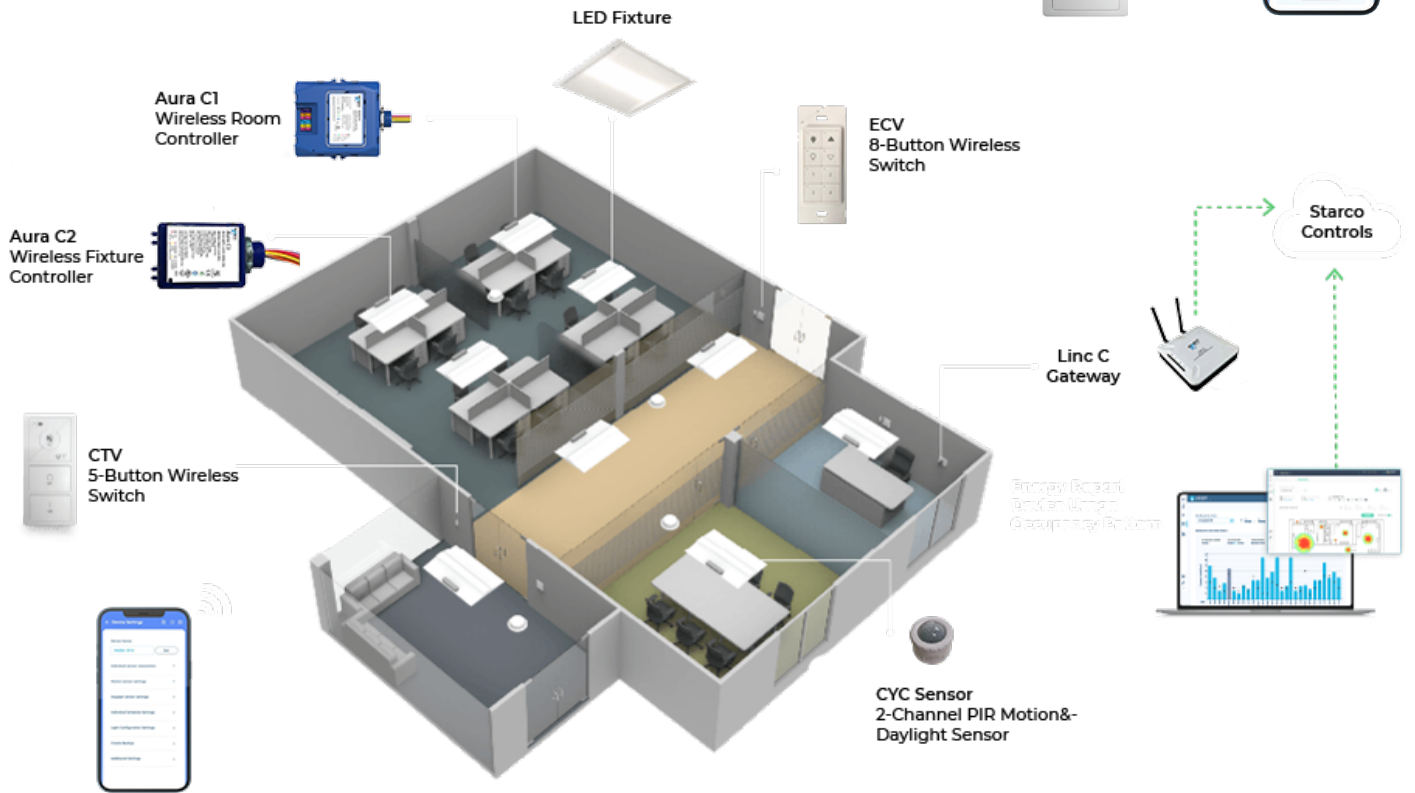

CF Sensor Coverage

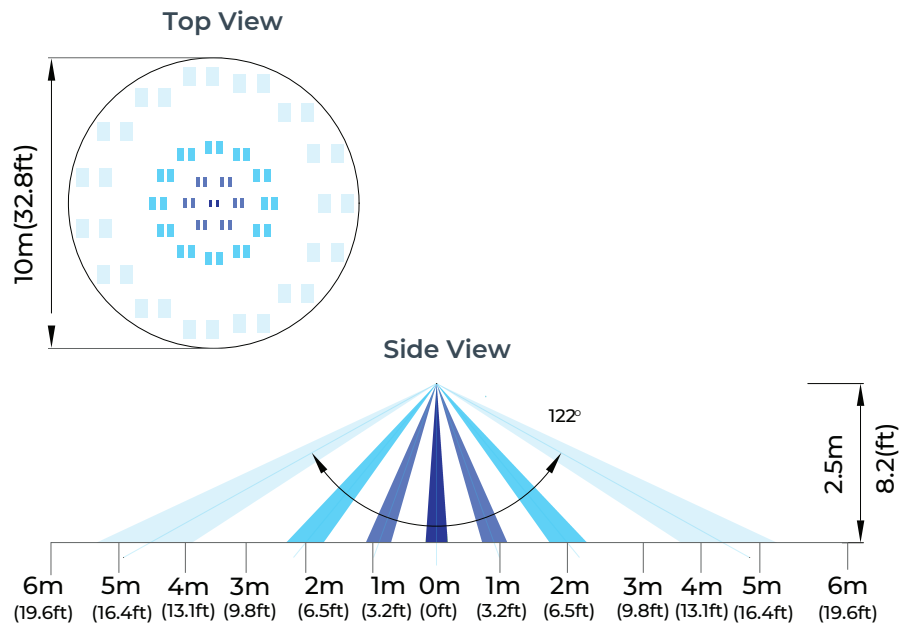

BMS Intergration

- Starco Control ecosystem leverages the Niagara framework to intergrate with any of the 120+ BMS protocols.
- Very simple to connect as plugging the two systems into a common Ethernet network.
- All data can be shared and BMS can monitor and control the lighting system.
- Adding OpendADR gateway, the customer can take advantage of any current or future utility demand response programs including peak pricing, capacity bidding and direct laod control

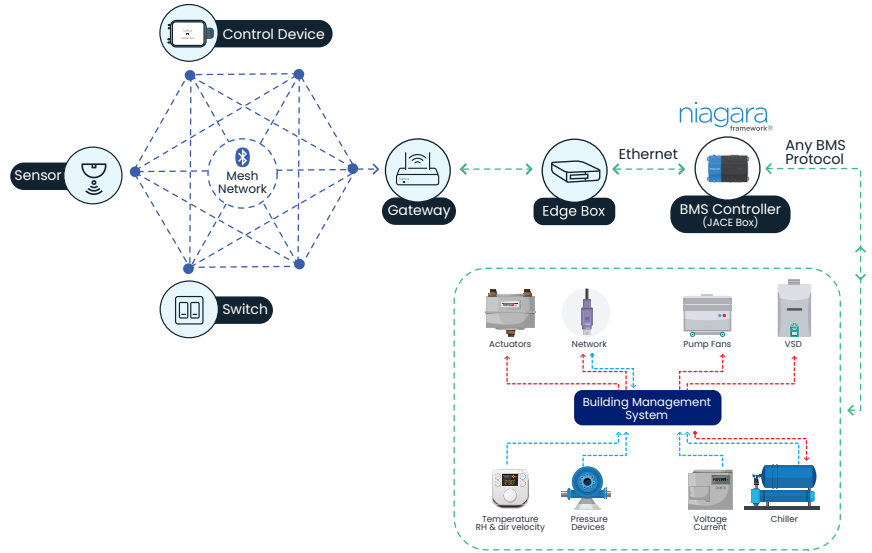

Mobile App

- For commission, configuration and controlling lighting networks including device replacement feature that makes commission easier.
- Setting up schedules, scenes and animations for individual devices or groups or zones
- Always get the latest features and improvements using OTA updates for devices
- Safe and reliable communication with AES 128-bit encryption and ensure safety using 4-digit code

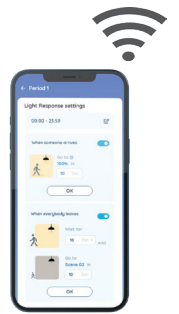

Emergency Lighting Control

- UL924 Listed Aura C1/C2 provides transfer operation during a power outage.
- When there is power outage, the controller will receive power from the emergency source via the ATS. The AC/DC power supply will turn OFF due to power outage and the 0-10V input channel of the controller will not sense any voltage. When the controller detects this, it switches over to Emergency Mode where the fixtures will be lit at 100% intensity for 90 mins.
- The BLE wireless Emergency Inverter interfaces with a battery and LED driver to provide much more than just self-test functionality. It can provide emergency testing reports through the mobile app and also provide fault notifications as soon as one is detect

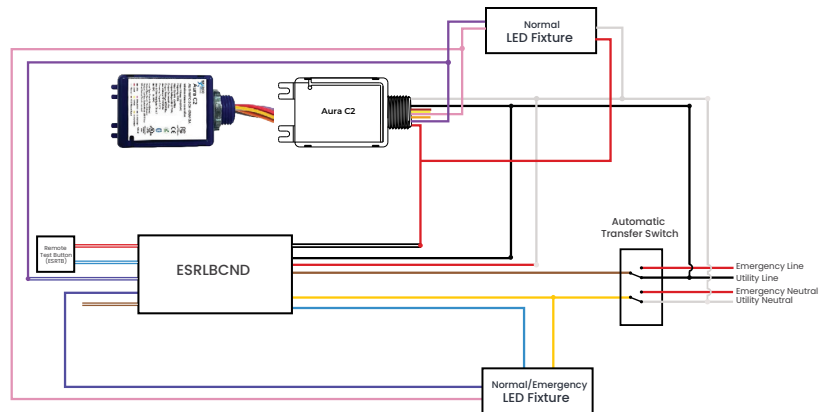

Radair AF10 - Wire description		
Line (Black)	12VDC (Yellow)	0-10V DIM+ (Purple)
Neutral (White)	DIM- (Pink)	0-3V Sensor input (Brown)
Load (Red)	0-10V DIM2+ (Orange)	

ESRLBCND - Wire description		
<b>Feedback/Dimmer Contacts</b>	<b>Remote Test Input</b>	
NO (White/Violet)	White/Red	Normal Hot (Black)
C (Violet)	White/Blue	Normal Switched Hot (White/Black)
N/C (White/Brown)		Normal Neutral (Red)
		Emergency Neutral (Yellow)
		Emergency Hot (Brown)
		Emergency Hot to Load (Blue)



Standard Efficacy

1'x4'

Model	Wattage	CCT	Size	Lumen Output
SLLP-14-15-30-80-SD-SE	15	3000K	1x4	1900
SLLP-14-15-35-80-SD-SE	15	3500K	1x4	1950
SLLP-14-15-40-80-SD-SE	15	4000K	1x4	2000
SLLP-14-15-40-80-SD-SE	15	5000K	1x4	2000
SLLP-14-20-30-80-SD-SE	20	3000K	1x4	2470
SLLP-14-20-35-80-SD-SE	20	3500K	1x4	2520
SLLP-14-20-40-80-SD-SE	20	4000K	1x4	2600
SLLP-14-20-50-80-SD-SE	20	5000K	1x4	2600
SLLP-14-25-30-80-SD-SE	25	3000K	1x4	3087
SLLP-14-25-35-80-SD-SE	25	3500K	1x4	3150
SLLP-14-25-40-80-SD-SE	25	4000K	1x4	3250
SLLP-14-25-50-80-SD-SE	25	5000K	1x4	3250
SLLP-14-30-30-80-SD-SE	30	3000K	1x4	3750
SLLP-14-30-35-80-SD-SE	30	3500K	1x4	3800
SLLP-14-30-40-80-SD-SE	30	4000K	1x4	3900
SLLP-14-30-50-80-SD-SE	30	5000K	1x4	3950
SLLP-14-35-30-80-SD-SE	35	3000K	1x4	4322
SLLP-14-35-35-80-SD-SE	35	3500K	1x4	4400
SLLP-14-35-40-80-SD-SE	35	4000K	1x4	4550
SLLP-14-35-50-80-SD-SE	35	5000K	1x4	4550

2'x2'

SLLP-22-15-30-80-SD-SE	15	3000K	2x2	1950
SLLP-22-15-35-80-SD-SE	15	3500K	2x2	1960
SLLP-22-15-40-80-SD-SE	15	4000K	2x2	2600
SLLP-22-15-50-80-SD-SE	15	5000K	2x2	2600
SLLP-22-20-30-80-SD-SE	20	3000K	2x2	2480
SLLP-22-20-35-80-SD-SE	20	3500K	2x2	2550
SLLP-22-20-40-80-SD-SE	20	4000K	2x2	2600
SLLP-22-20-50-80-SD-SE	20	5000K	2x2	2600
SLLP-22-25-30-80-SD-SE	25	3000K	2x2	3087
SLLP-22-25-35-80-SD-SE	25	3500K	2x2	3150
SLLP-22-25-40-80-SD-SE	25	4000K	2x2	3250
SLLP-22-25-50-80-SD-SE	25	5000K	2x2	3250
SLLP-22-30-30-80-SD-SE	30	3000K	2x2	3750
SLLP-22-30-35-80-SD-SE	30	3500K	2x2	3800
SLLP-22-30-40-80-SD-SE	30	4000K	2x2	3900
SLLP-22-30-50-80-SD-SE	30	5000K	2x2	3950
SLLP-22-35-30-80-SD-SE	35	3000K	2x2	4322
SLLP-22-35-35-80-SD-SE	35	3500K	2x2	4400
SLLP-22-35-40-80-SD-SE	35	4000K	2x2	4550
SLLP-22-35-50-80-SD-SE	35	5000K	2x2	4550

Standard Efficacy  
2'x4'

Model	Wattage	CCT	Size	Lumen Output
SLLP-24-20-30-80-SD-SE	20	3000K	2x4	2480
SLLP-24-20-35-80-SD-SE	20	3500K	2x4	2550
SLLP-24-20-40-80-SD-SE	20	4000K	2x4	2600
SLLP-24-20-50-80-SD-SE	20	5000K	2x4	2600
SLLP-24-25-30-80-SD-SE	25	3000K	2x4	3087
SLLP-24-25-35-80-SD-SE	25	3500K	2x4	3150
SLLP-24-25-40-80-SD-SE	25	4000K	2x4	3250
SLLP-24-25-50-80-SD-SE	25	5000K	2x4	3250
SLLP-24-30-30-80-SD-SE	30	3000K	2x4	3750
SLLP-24-30-35-80-SD-SE	30	3500K	2x4	3800
SLLP-24-30-40-80-SD-SE	30	4000K	2x4	3900
SLLP-24-30-50-80-SD-SE	30	5000K	2x4	3950
SLLP-24-35-30-80-SD-SE	35	3000K	2x4	4322
SLLP-24-35-35-80-SD-SE	35	3500K	2x4	4400
SLLP-24-35-40-80-SD-SE	35	4000K	2x4	4550
SLLP-24-35-50-80-SD-SE	35	5000K	2x4	4550
SLLP-24-40-30-80-SD-SE	40	3000K	2x4	4940
SLLP-24-40-35-80-SD-SE	40	3500K	2x4	5100
SLLP-24-40-40-80-SD-SE	40	4000K	2x4	5200
SLLP-24-40-50-80-SD-SE	40	5000K	2x4	5200
SLLP-24-45-30-80-SD-SE	45	3000K	2x4	5557
SLLP-24-45-35-80-SD-SE	45	3500K	2x4	5700
SLLP-24-45-40-80-SD-SE	45	4000K	2x4	5850
SLLP-24-45-50-80-SD-SE	45	5000K	2x4	5850
SLLP-24-50-30-80-SD-SE	50	3000K	2x4	6175
SLLP-24-50-35-80-SD-SE	50	3500K	2x4	6300
SLLP-24-50-40-80-SD-SE	50	4000K	2x4	6500
SLLP-24-50-50-80-SD-SE	50	5000K	2x4	6500
SLLP-24-55-30-80-SD-SE	55	3000K	2x4	6792
SLLP-24-55-35-80-SD-SE	55	3500K	2x4	7000
SLLP-24-55-40-80-SD-SE	55	4000K	2x4	7150
SLLP-24-55-50-80-SD-SE	55	5000K	2x4	7150

High Efficacy  
2'x4'

Model	Wattage	CCT	Size	Lumen Output
SLLP-24-20-30-80-SD-HE	20	3000K	2x4	2850
SLLP-24-20-35-80-SD-HE	20	3500K	2x4	2900
SLLP-24-20-40-80-SD-HE	20	4000K	2x4	3000
SLLP-24-20-50-80-SD-HE	20	5000K	2x4	3000
SLLP-24-25-30-80-SD-HE	25	3000K	2x4	3600
SLLP-24-25-35-80-SD-HE	25	3500K	2x4	3650
SLLP-24-25-40-80-SD-HE	25	4000K	2x4	3750
SLLP-24-25-50-80-SD-HE	25	5000K	2x4	3750
SLLP-24-30-30-80-SD-HE	30	3000K	2x4	4350
SLLP-24-30-35-80-SD-HE	30	3500K	2x4	4400
SLLP-24-30-40-80-SD-HE	30	4000K	2x4	4500
SLLP-24-30-50-80-SD-HE	30	5000K	2x4	4500
SLLP-24-35-30-80-SD-HE	35	3000K	2x4	5100
SLLP-24-35-35-80-SD-HE	35	3500K	2x4	5150
SLLP-24-35-40-80-SD-HE	35	4000K	2x4	5250
SLLP-24-35-50-80-SD-HE	35	5000K	2x4	5250
SLLP-24-40-30-80-SD-HE	40	3000K	2x4	5850
SLLP-24-40-35-80-SD-HE	40	3500K	2x4	5900
SLLP-24-40-40-80-SD-HE	40	4000K	2x4	6000
SLLP-24-40-50-80-SD-HE	40	5000K	2x4	6000
SLLP-24-45-30-80-SD-HE	45	3000K	2x4	6500
SLLP-24-45-35-80-SD-HE	45	3500K	2x4	6600
SLLP-24-45-40-80-SD-HE	45	4000K	2x4	6750
SLLP-24-45-50-80-SD-HE	45	5000K	2x4	6750
SLLP-24-50-30-80-SD-HE	50	3000K	2x4	7200
SLLP-24-50-35-80-SD-HE	50	3500K	2x4	7300
SLLP-24-50-40-80-SD-HE	50	4000K	2x4	7500
SLLP-24-50-50-80-SD-HE	50	5000K	2x4	7500
SLLP-24-55-30-80-SD-HE	55	3000K	2x4	8000
SLLP-24-55-35-80-SD-HE	55	3500K	2x4	8100
SLLP-24-55-40-80-SD-HE	55	4000K	2x4	8250
SLLP-24-55-50-80-SD-HE	55	5000K	2x4	8250

High Efficacy

1'x4'

Model	Wattage	CCT	Size	Lumen Output
SLLP-14-15-30-80-SD-HE	15	3000K	1x4	2100
SLLP-14-15-35-80-SD-HE	15	3500K	1x4	2200
SLLP-14-15-40-80-SD-HE	15	4000K	1x4	2250
SLLP-14-15-40-80-SD-HE	15	5000K	1x4	2250
SLLP-14-20-30-80-SD-HE	20	3000K	1x4	2850
SLLP-14-20-35-80-SD-HE	20	3500K	1x4	2900
SLLP-14-20-40-80-SD-HE	20	4000K	1x4	3000
SLLP-14-20-50-80-SD-HE	20	5000K	1x4	3000
SLLP-14-25-30-80-SD-HE	25	3000K	1x4	3600
SLLP-14-25-35-80-SD-HE	25	3500K	1x4	3650
SLLP-14-25-40-80-SD-HE	25	4000K	1x4	3750
SLLP-14-25-50-80-SD-HE	25	5000K	1x4	3750
SLLP-14-30-30-80-SD-HE	30	3000K	1x4	4350
SLLP-14-30-35-80-SD-HE	30	3500K	1x4	4400
SLLP-14-30-40-80-SD-HE	30	4000K	1x4	4500
SLLP-14-30-50-80-SD-HE	30	5000K	1x4	4500
SLLP-14-35-30-80-SD-HE	35	3000K	1x4	5050
SLLP-14-35-35-80-SD-HE	35	3500K	1x4	5100
SLLP-14-35-40-80-SD-HE	35	4000K	1x4	5250
SLLP-14-35-50-80-SD-HE	35	5000K	1x4	5250

2'x2'

SLLP-22-15-30-80-SD-HE	15	3000K	2x2	2100
SLLP-22-15-35-80-SD-HE	15	3500K	2x2	2200
SLLP-22-15-40-80-SD-HE	15	4000K	2x2	2250
SLLP-22-15-50-80-SD-HE	15	5000K	2x2	2250
SLLP-22-20-30-80-SD-HE	20	3000K	2x2	2850
SLLP-22-20-35-80-SD-HE	20	3500K	2x2	2900
SLLP-22-20-40-80-SD-HE	20	4000K	2x2	3000
SLLP-22-20-50-80-SD-HE	20	5000K	2x2	3000
SLLP-22-25-30-80-SD-HE	25	3000K	2x2	3600
SLLP-22-25-35-80-SD-HE	25	3500K	2x2	3650
SLLP-22-25-40-80-SD-HE	25	4000K	2x2	3750
SLLP-22-25-50-80-SD-HE	25	5000K	2x2	3750
SLLP-22-30-30-80-SD-HE	30	3000K	2x2	4350
SLLP-22-30-35-80-SD-HE	30	3500K	2x2	4400
SLLP-22-30-40-80-SD-HE	30	4000K	2x2	4500
SLLP-22-30-50-80-SD-HE	30	5000K	2x2	4500
SLLP-22-35-30-80-SD-HE	35	3000K	2x2	5050
SLLP-22-35-35-80-SD-HE	35	3500K	2x2	5100
SLLP-22-35-40-80-SD-HE	35	4000K	2x2	5250
SLLP-22-35-50-80-SD-HE	35	5000K	2x2	5250