



# SLTR - LED TROFFER RETROFIT KIT

Project:	
Type:	
Note:	

## DESCRIPTION

The Starco SLTR LED Troffer Retrofit Kit combines high efficiency (150 LPW) with versatility, offering 4 power settings and 5 selectable CCT options. Built with durable aluminum housing and a frosted PMMA lens, it delivers soft, uniform illumination ideal for modern spaces. UL listed for damp locations and featuring a 0-10V dimming driver, this kit ensures energy savings, long-lasting performance, and easy integration into existing fixtures.

## SPECIFICATION FEATURES

### Construction & Materials

- Luminaire housing are die formed of 22 code gauge prime cold rolled steel
- Extruded acrylic lens features linear prisms
- Extruded aluminum heatsink maximizes LED lifetime and optimal performance
- Light weight design allows for a less obtrusive installation

### Electrical System

- High efficiency driver
- Input Voltage: 120-277V, 347V/480V optional, 50/60Hz
- Operating Temperature: -20°C (-4°F) to 50°C (122°F)
- 0-10V Continuous dimming
- Power Factor: >0.90
- Total Harmonic Distortion: <15%
- Wireless Driver Standby (Off State) Power: >1W

### Optical System

- High impact acrylic optics provides even distribution
- Frosted lens provides maximum glare reduction

### LED

- CRI: 80+, 90+
- Color Selectable 3000K/3500K/4000K/5000K
- Color Tunable Range: 3000K to 5000K
- Reported L<sub>30</sub> Lifetime: 101,000 hours @25°C
- Reported L<sub>70</sub> Lifetime: 349,000 hours @25°C

### Warranty

- 10 Years

### Control & Networking

- Integrated sensor
- Integrated Wireless BLE Sensor
- Integrated Wireless BLE Driver
- Internet/Cloud base remote programming control

### Certification

- UL & cUL;
- DLC Premium;

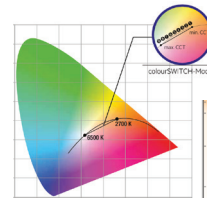
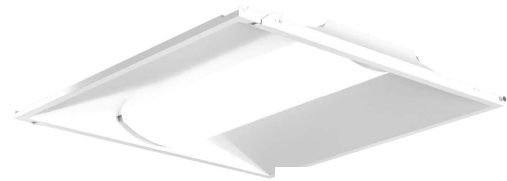

Dynamic Range 3000K to 5000K



## DIMENSION

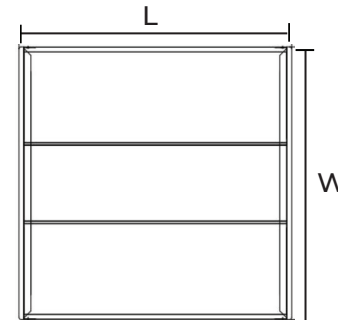
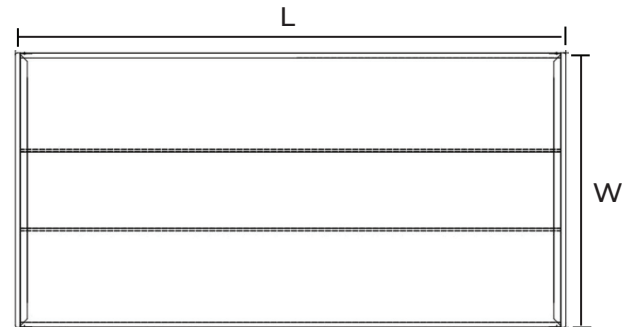

Model	L	W	H	Weight
1x4	47-3/4" 1213mm	11-3/4" 298mm	2-1/2" 63.5mm	9.8lbs
2x2	23-3/4" 603mm	23-3/4" 603mm	2-1/2" 63.5mm	10.0lbs
2x4	47-3/4" 1213mm	23-3/4" 603mm	2-1/2" 63.5mm	16.5lbs



Example: SLTR-24-20-CS-80-SD-HE

SLTR	Size	Wattage	CCT	CRI	Driver	Efficacy
SLTR=LED Troffer Retrofit Kit	14=1x4 22=2x2 24=2x4	15=15W 20=20W 30=30W 35=35W	CS=CCT Selectable 3000K/3500K/ 4000K/5000K/ 6500K  DR=Dynamic Color Tunable Range 3000K - 5000K	80=80CRI  90=90CRI	SD=Standard Driver CCT Selectable, 0-10V Dim  TD= Wireless BLE Tunable Driver	HE=High Efficacy 150 LPW

Options
<p><b>BAA = Buy America Act Compliant</b></p> <p><b>Standard Accessories</b></p> <p><b>Emergency Inverters</b> EMD-10=10W Emergency Inverter Pack EMD-20=20W Emergency Inverter Pack</p> <p><b>Dimmers</b> LVDC-A019=Rotary 0-10V Dimmer</p> <p><b>Switches</b> WMS=Wired 0-10V switch with motion sensor WOS=Wired 0-10V switch</p> <p><b>Wireless Accessories</b></p> <p><b>Sensors</b> CAP=AC powered wireless PIR motion &amp; light sensor CAM=AC powered wireless microwave motion &amp; light sensor CYC=DC powered dual channel PIR motion &amp; light sensor</p> <p><b>Switches</b> CIV=Wireless 4 button switch CTV=Wireless 5 button switch ECV=Wireless 8 button switch MOV=Wireless 1 button switch with motion sensor OSC=Wireless 1 button switch</p> <p><b>Gateway &amp; Extenders</b> ECHO=Beacon &amp; range extender LINCC=Gateway with ethernet &amp; RTC</p> <p><b>Emergency Inverters</b> EMDW-10=10W Emergency Inverter Wireless Pack EMDW-20=20W Emergency Inverter Wireless Pack</p>

Emergency Battery Pack Options - Field Installable

Battery Model Number	Wattage	Runtime(minutes)	Lumen Output	Other
EMD(W)-10	10W	90	1300-1500	Self Diagnostic
EMD(W)-20	20W	90	2600-3000	Self Diagnostic

How does the control platform works?

1. Install the SLTR troffer retrofit kit with integrated smart sensor or wireless driver
2. Install the wireless self-powered wall switches
3. With Starco app, pair the troffers with the wall switches and any additional stand-alone sensors
4. Customize the sensor settings and fixture schedules as needed

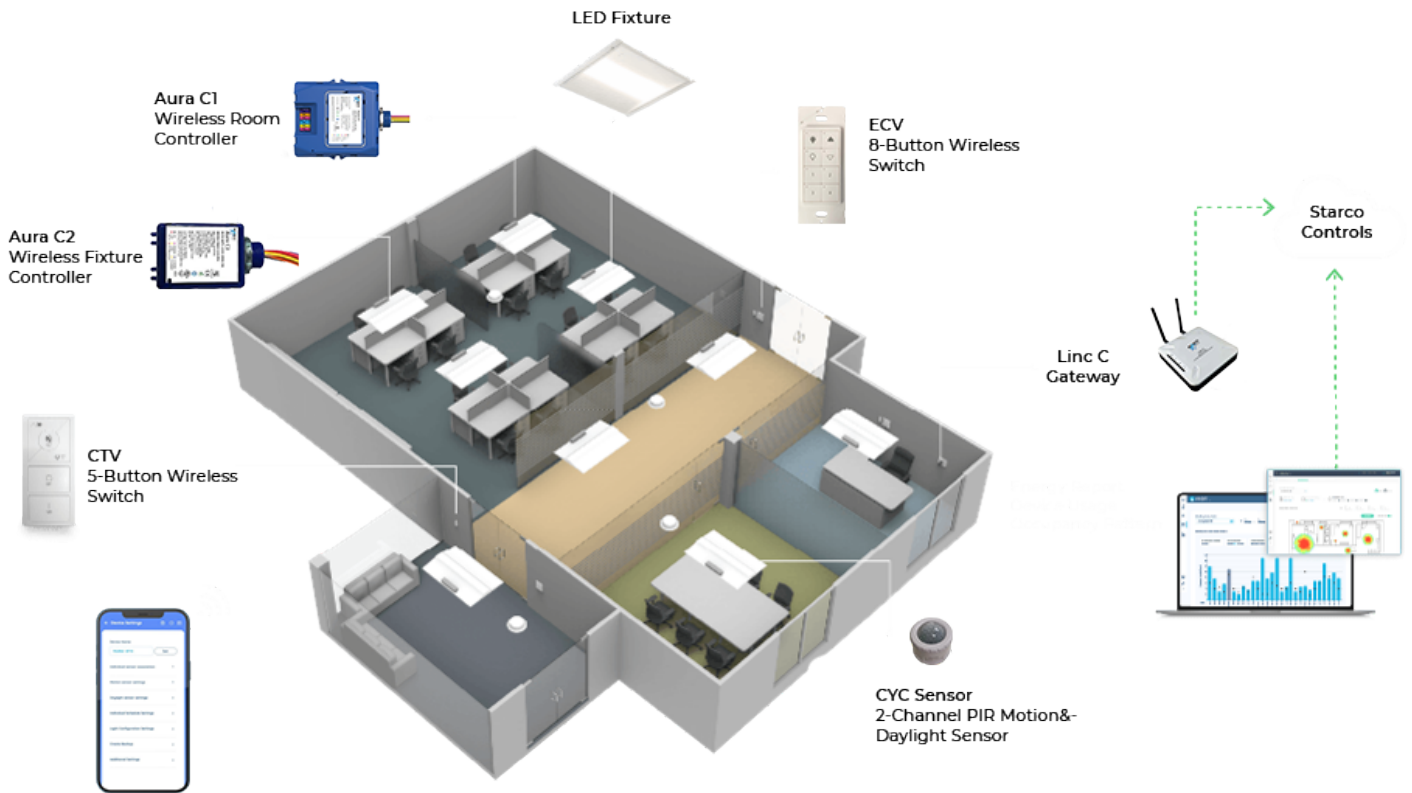

Sensor Coverage

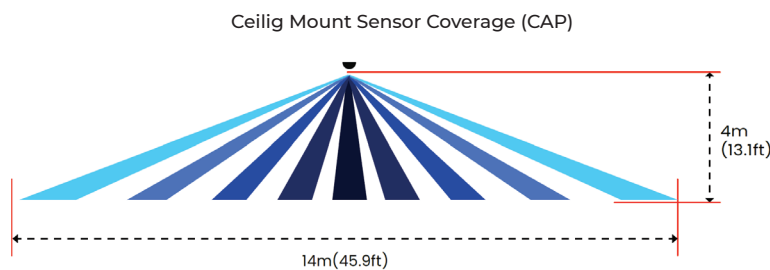

Fixture Sensor Coverage (CYC)

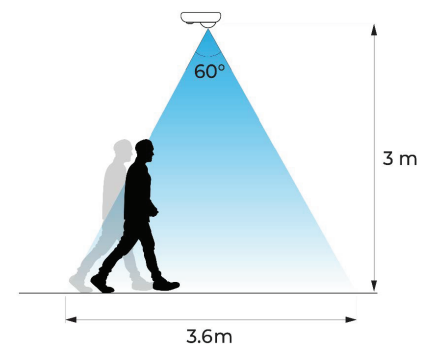

Bluetooth Mesh Features

- **Communication Performance** - Flood management protocols along with optimized communication strategies enable high reliability and performance within the mesh network and to edge interface devices like mobile and web UI.
- **Update Performance** - Unique advertisement based update mechanisms capable of securely updating thousands of devices simultaneously in a couple hours while maintain reliable functionality and performance of the mesh network.
- **Security** - Multi-level security achieved using different keys for device commissioning, communicating within mesh and cloud communication.
- **Time synchronization** - Cloud or real time clock centralized devices provide most cost-effective and reliable time clock management to maintain proper schedules.

BMS Intergration

- Starco Control ecosystem leverages the Niagara framework to intergrate with any of the 120+ BMS protocols.
- Very simple to connect as plugging the two systems into a common Ethernet network.
- All data can be shared and BMS can monitor and control the lighting system.
- Adding OpendADR gateway, the customer can take advantage of any current or future utility demand response programs including peak pricing, capacity bidding and direct laod control

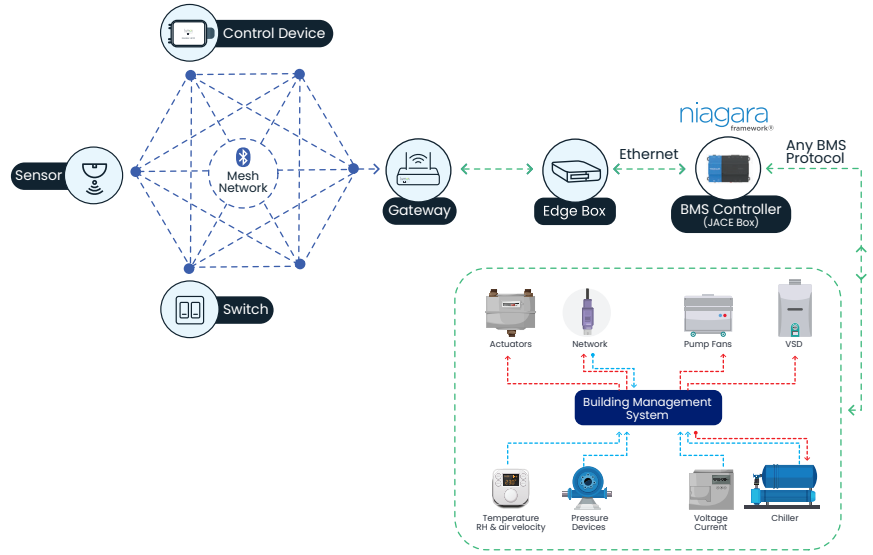

Mobile App

- For commission, configuration and controlling lighting networks including device replacement feature that makes commission easier.
- Setting up schedules, scenes and animations for individual devices or groups or zones
- Always get the latest features and improvements using OTA updates for devices
- Safe and reliable communication with AES 128-bit encryption and ensure safety using 4-digit code

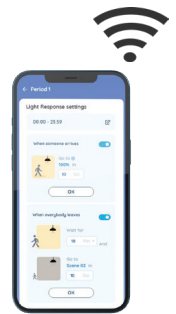

Emergency Lighting Control

- UL924 Listed Aura C1/C2 provides transfer operation during a power outage.
- When there is power outage, the controller will receive power from the emergency source via the ATS. The AC/DC power supply will turn OFF due to power outage and the 0-10V input channel of the controller will not sense any voltage. When the controller detects this, it switches over to Emergency Mode where the fixtures will be lit at 100% intensity for 90 mins.
- The BLE wireless Emergency Inverter interfaces with a battery and LED driver to provide much more than just self-test functionality. It can provide emergency testing reports through the mobile app and also provide fault notifications as soon as one is detect

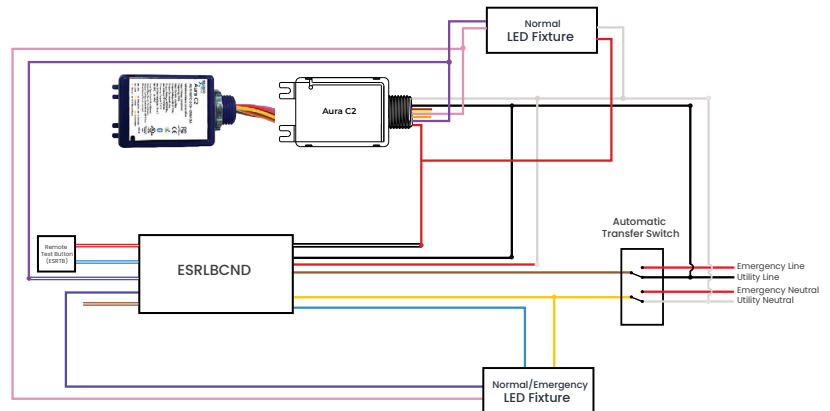

Radiar AF10 - Wire description		
Line (Black)	12VDC (Yellow)	0-10V DIM1+ (Purple)
Neutral (White)	DIM- (Pink)	0-3V Sensor input (Brown)
Load (Red)	0-10V DIM2+ (Orange)	

ESRLBCND - Wire description		
<b>Feedback/Dimmer Contacts</b>	<b>Remote Test Input</b>	
NO (White/Violet)	White/Red	Normal Hot (Black)
C (Violet)	White/Blue	Normal Switched Hot (White/Black)
N/C (White/Brown)		Normal Neutral (Red)
		Emergency Neutral (Yellow)
		Emergency Hot (Brown)
		Emergency Hot to Load (Blue)



High Efficacy

Model	Wattage	CCT	Size	Lumen Output
SLTR-14-15-CS-80-SD-HE	15	3000K	1x4	2220
SLTR-14-15-CS-80-SD-HE	15	3500K	1x4	2250
SLTR-14-15-CS-80-SD-HE	15	4000K	1x4	2400
SLTR-14-15-CS-80-SD-HE	15	5000K	1x4	2370
SLTR-14-15-CS-80-SD-HE	15	6500K	1x4	2450
SLTR-14-20-CS-80-SD-HE	20	3000K	1x4	2950
SLTR-14-20-CS-80-SD-HE	20	3500K	1x4	3000
SLTR-14-20-CS-80-SD-HE	20	4000K	1x4	3200
SLTR-14-20-CS-80-SD-HE	20	5000K	1x4	3180
SLTR-14-20-CS-80-SD-HE	20	6500K	1x4	3250
SLTR-14-30-CS-80-SD-HE	30	3000K	1x4	4440
SLTR-14-30-CS-80-SD-HE	30	3500K	1x4	4500
SLTR-14-30-CS-80-SD-HE	30	4000K	1x4	4850
SLTR-14-30-CS-80-SD-HE	30	5000K	1x4	4800
SLTR-14-30-CS-80-SD-HE	30	6500K	1x4	4950
SLTR-22-15-CS-80-SD-HE	15	3000K	2x2	2220
SLTR-22-15-CS-80-SD-HE	15	3500K	2x2	2250
SLTR-22-15-CS-80-SD-HE	15	4000K	2x2	2400
SLTR-22-15-CS-80-SD-HE	15	5000K	2x2	2370
SLTR-22-15-CS-80-SD-HE	15	6500K	2x2	2450
SLTR-22-20-CS-80-SD-HE	20	3000K	2x2	2950
SLTR-22-20-CS-80-SD-HE	20	3500K	2x2	3000
SLTR-22-20-CS-80-SD-HE	20	4000K	2x2	3200
SLTR-22-20-CS-80-SD-HE	20	5000K	2x2	3180
SLTR-22-20-CS-80-SD-HE	20	6500K	2x2	3250
SLTR-22-30-CS-80-SD-HE	30	3000K	2x2	4440
SLTR-22-30-CS-80-SD-HE	30	3500K	2x2	4500
SLTR-22-30-CS80-SD-HE	30	4000K	2x2	4850
SLTR-22-30-CS-80-SD-HE	30	5000K	2x2	4800
SLTR-22-30-CS-80-SD-HE	30	6500K	2x2	4950
SLTR-24-20-CS-80-SD-HE	20	3000K	2x4	2950
SLTR-24-20-CS-80-SD-HE	20	3500K	2x4	3000
SLTR-24-20-CS-80-SD-HE	20	4000K	2x4	3200
SLTR-24-20-CS-80-SD-HE	20	5000K	2x4	3180
SLTR-24-20-CS-80-SD-HE	20	6500K	2x4	3250
SLTR-24-30-CS-80-SD-HE	30	3000K	2x4	4440
SLTR-24-30-CS-80-SD-HE	30	3500K	2x4	4500
SLTR-24-30-CS-80-SD-HE	30	4000K	2x4	4850
SLTR-24-30-CS-80-SD-HE	30	5000K	2x4	4800
SLTR-24-30-CS-80-SD-HE	30	6500K	2x4	4950
SLTR-24-35-CS-80-SD-HE	35	3000K	2x4	5215
SLTR-24-35-CS-80-SD-HE	35	3500K	2x4	5250
SLTR-24-35-CS-80-SD-HE	35	4000K	2x4	5600
SLTR-24-35-CS-80-SD-HE	35	5000K	2x4	5550
SLTR-24-35-CS-80-SD-HE	35	6500K	2x4	5700