



Starco Lighting Inc  
2495 Main Street, Suite#218 Buffalo NY 14214  
info@starcous.com 716-931-9322

## Installation Instruction - SE LED Strip Retrofit Kit

### Warning, cautions and operating instructions

- To reduce the risk of death, personal injury or property damage from fire, electric shock, falling parts, cuts/abrasions, and other hazards read all warnings and instructions included with and on the fixture box and all fixture labels.
- Before installing, servicing, or performing routine maintenance upon this equipment, follow these general precautions.
- Commercial installation, service and maintenance of luminaires should be performed by a qualified licensed electrician.
- For the installation: If you are unsure about the installation or maintenance of the luminaires, consult a qualified licensed electrician and check your local electrical code.
- To prevent wiring damage or abrasion, do not expose wiring to edges of sheet metal or other sharp objects.
- Do not make or alter any open holes in an enclosure of wiring or electrical components during kit installation.

### Warning: Risk of fire or electrical shock

- Turn off electrical power at fuse or circuit breaker box before wiring fixture to the power supply.
- Turn off the power when you perform any maintenance.
- Verify that supply voltage is correct by comparing it with the luminaire label information.
- Make all electrical and grounded connections in accordance with the National Electrical Code and any applicable local code requirements.
- All wiring connections should be capped with UL approved wire connectors.

### Caution: Risk of injury

- Avoid direct eye exposure to the light source while it is on.
- Account for small parts and destroy packing material, as these may be hazardous to children.
- Risk of burn. Disconnect power and allow fixture to cool before changing bulb or handing fixture.

NOTICE: Green ground screw provided in proper location. Do not relocate.

NOTICE: Minimum 90°C supply conductors.

NOTICE: Specifications and dimensions subject to change without notice.

NOTICE: Suitable for Dry or Damp location, Type IC.

### Dimensions

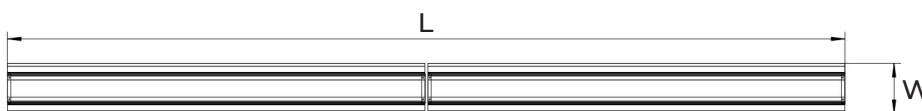
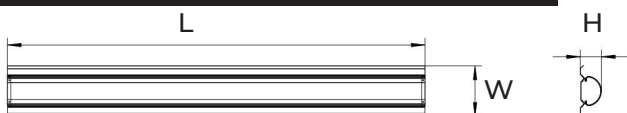

Model	L	W	H
4'	1220	148	62
8'	2446	148	62

These kits have been fully tested and properly mounted in fixtures closely matching the kit's intended application.

Tested Housing Model Numbers:  
Lithonia C2 32 MVOLT GEB10IS  
Lithonia TC2 32 MVOLT GEB10IS

# Installation Instruction - SE LED Strip Retrofit Kit

## Wiring Diagram



## 4FT Strip Mounting

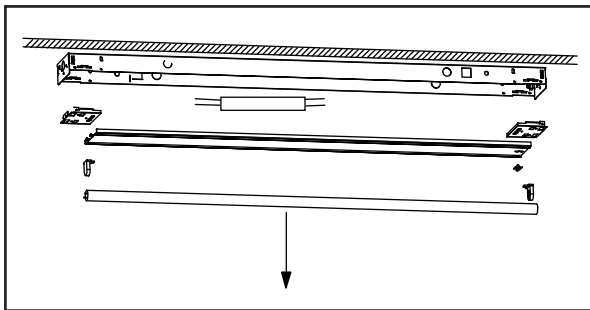

Step 1.

Shut off power to the existing fixture. Disconnect power supply wires from the existing ballast. Remove and discard the original fixture lamp(s), ballast cover, ballast, socket bars, and associated wiring.

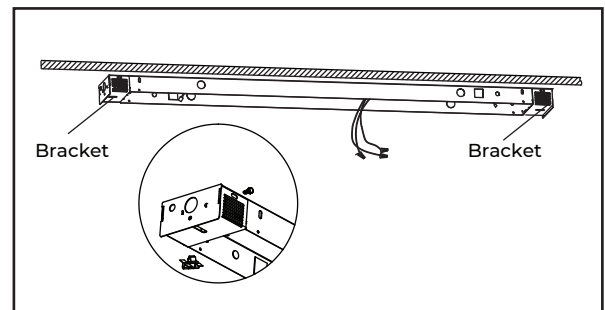

Step 2.

Install brackets on both sides of the existing fixture housing using screws.

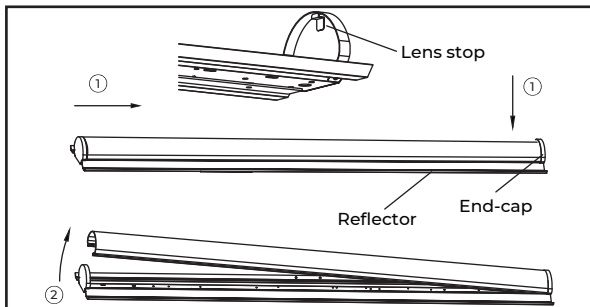

Step 3.

Slide the lens at least 4-5 mm while pressing one end past the internal lens stop inside the end cap, then carefully remove the lens.

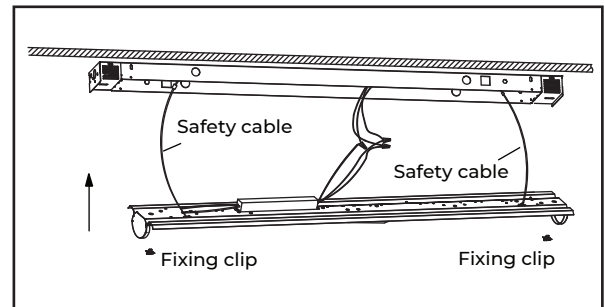

Step 4.

Secure the safety cables to the original housing using screws. Hang the LED retrofit assembly from the cables, make the electrical connections, and fasten the assembly using fixing clips.

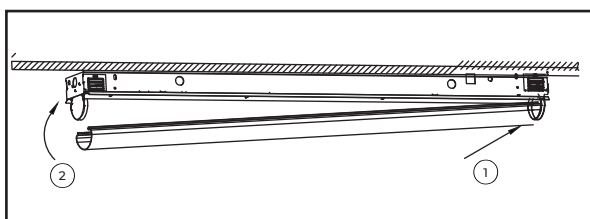

Step 5.

Depress and insert the lens stop inside the end cap. Snap the lens upward into the reflector track. Carefully slide the lens and ensure both ends are fully enclosed by the end caps. Verify that the end caps are properly aligned and perpendicular to the reflector.

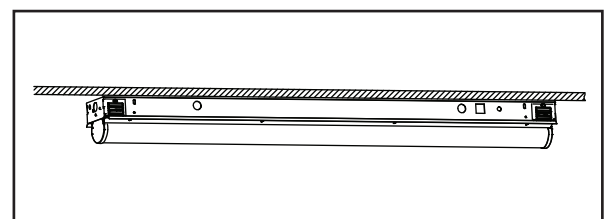

Step 6.

Clean the lens using a non-abrasive cleaning solution. Restore power and turn on the fixture.

# Installation Instruction - SE LED Strip Retrofit Kit

## 8FT Strip Mounting

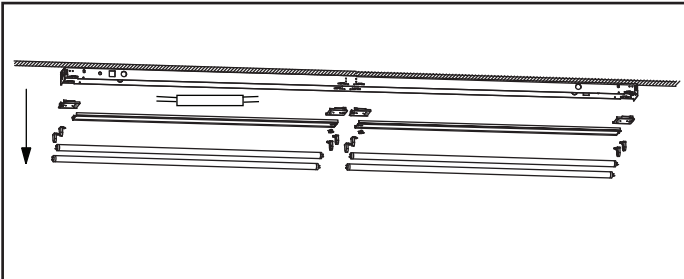

### Step 1.

Shut off power to the existing fixture. Disconnect power supply wires from the existing ballast. Remove and discard the original fixture lamp(s), ballast cover, ballast, socket bars, and associated wiring.

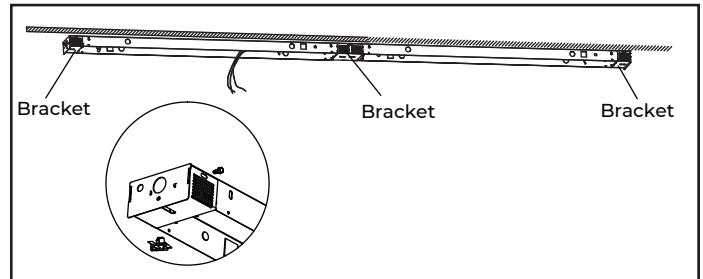

### Step 2.

Install brackets on both sides and center of the existing fixture housing using screws.

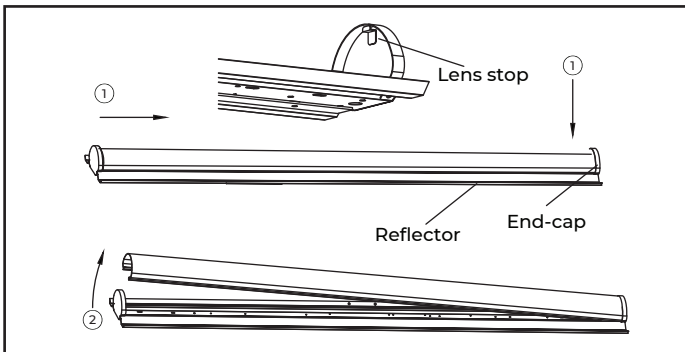

### Step 3.

Slide the lens at least 4-5 mm while pressing one end past the internal lens stop inside the end cap, then carefully remove the lens. Repeat the above actions to remove the lens of the other half fixture.

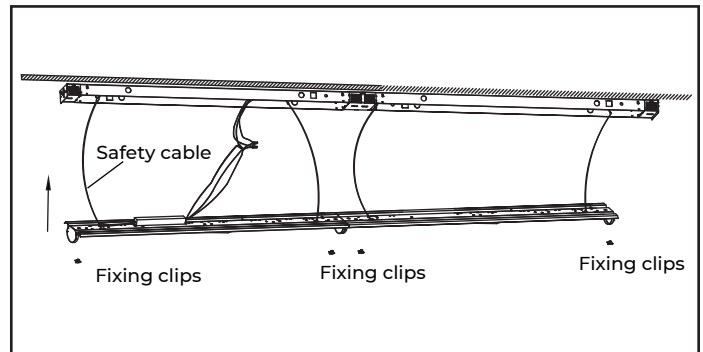

### Step 4.

Secure the safety cables to the original housing using screws. Hang the LED retrofit assembly from the cables, make the electrical connections, and fasten the assembly using fixing clips.

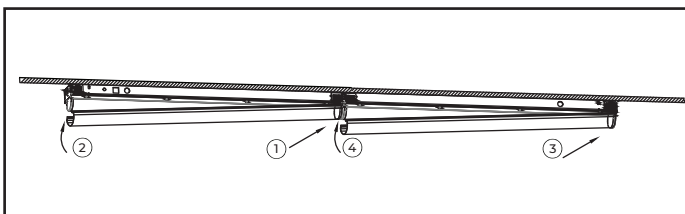

### Step 5.

Depress and insert the lens past the lens stop inside the end cap. Snap the lens upward into the reflector track. Carefully slide the lens and ensure both ends are fully enclosed by the end caps. Verify that the end caps are properly aligned and perpendicular to the reflector.

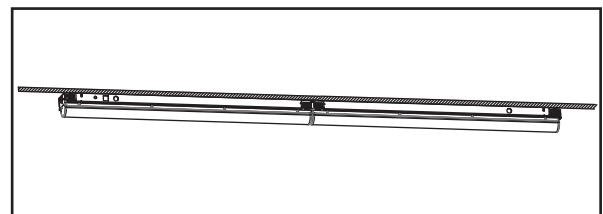

### Step 6.

Clean the lens using a non-abrasive cleaning solution. Restore power and turn on the fixture.

# Installation Instruction - SE LED Strip Retrofit Kit

## Sensor Mounting

Step 1.  
Remove the sensor hole cover.

Step 2.  
Insert the sensor into the hole and rotate it until it is securely fitted.

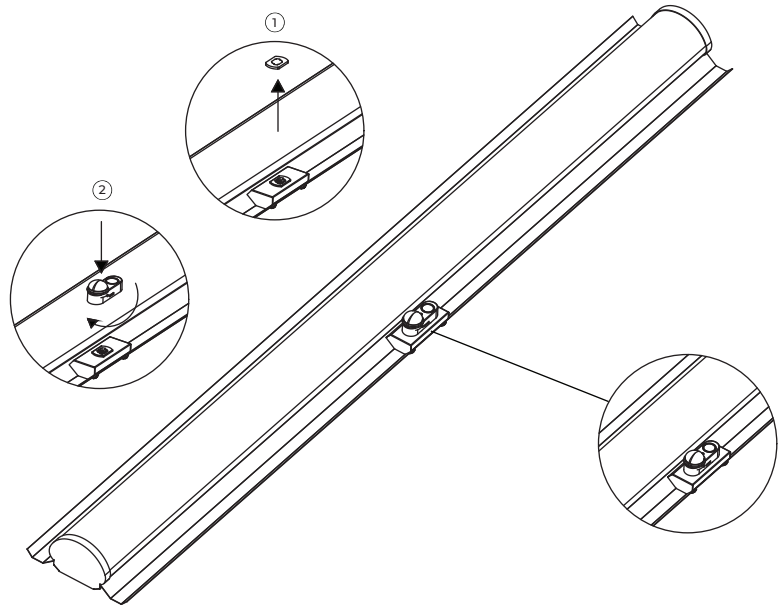

## Field-Adjust Power and CCT

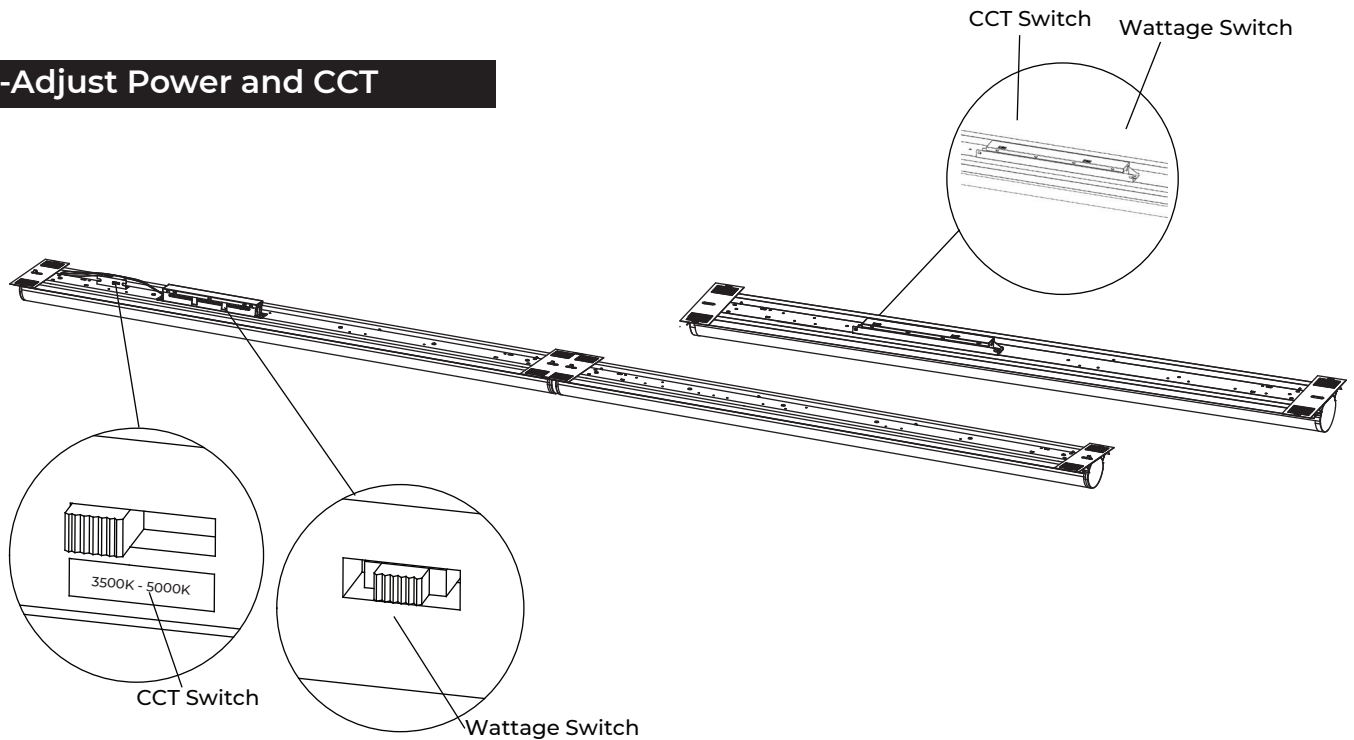

End users can adjust the color temperature and wattage using the two switches located on the driver. Each switch offers multiple positions, corresponding to different color temperatures and wattage options. These settings allow for customized combinations of color temperature and light output.

1. The switches are located on the driver enclosure.
2. Select the desired wattage and color temperature by sliding the switches left, middle, or right accordingly.